

**TAXI CABINETS PRICE LIST UPDATED APRIL 2008**

PRICES, SPECIFICATIONS AND AVAILABILITY SUBJECT TO CHANGE WITHOUT NOTICE



ITEM	DESCRIPTION	TIMES SQ MAPLE
------	-------------	-------------------

\*\*\*\*\*NOTE: TIMES SQ MAPLE DOUBLE DOOR CABINETS HAVE BUTT DOORS ( NO CENTER STILE) EXCEPT W3042

**30" HIGH WALL CABINETS**

W0930	WALL - 9"W x 12"D x 30"H - 1 DOOR	81.32
W1230	WALL - 12"W x 12"D x 30"H - 1 DOOR	90.44
W1530	WALL - 15"W x 12"D x 30"H - 1 DOOR	98.04
W1830	WALL - 18"W x 12"D x 30"H - 1 DOOR	109.44
W2130	WALL - 21"W x 12"D x 30"H - 1 DOOR	131.48
W2430	WALL - 24"W x 12"D x 30"H - 2 DOORS	132.76
W2730	WALL - 27"W x 12"D x 30"H - 2 DOORS	152.76
W3030	WALL - 30"W x 12"D x 30"H - 2 DOORS	159.60
W3330	WALL - 33"W x 12"D x 30"H - 2 DOORS	171.00
W3630	WALL - 36"W x 12"D x 30"H - 2 DOORS	182.40
W4230	WALL - 42"W x 12"D x 30"H - 2 DOORS	211.28

**36" HIGH WALL CABINETS**

W0936	WALL - 9"W x 12"D x 36"H - 1 DOOR	103.36
W1236	WALL - 12"W x 12"D x 36"H - 1 DOOR	108.68
W1536	WALL - 15"W x 12"D x 36"H - 1 DOOR	117.80
W1836	WALL - 18"W x 12"D x 36"H - 1 DOOR	131.48
W2136	WALL - 21"W x 12"D x 36"H - 1 DOOR	157.52
W2436	WALL - 24"W x 12"D x 36"H - 2 DOORS	168.72
W2736	WALL - 27"W x 12"D x 36"H - 2 DOORS	190.76
W3036	WALL - 30"W x 12"D x 36"H - 2 DOORS	205.20
W3336	WALL - 33"W x 12"D x 36"H - 2 DOORS	218.88
W3636	WALL - 36"W x 12"D x 36"H - 2 DOORS	228.76

**42" HIGH WALL CABINETS**

W0942	WALL - 9"W x 12"D x 42"H - 1 DOOR	114.00
W1242	WALL - 12"W x 12"D x 42"H - 1 DOOR	120.08
W1542	WALL - 15"W x 12"D x 42"H - 1 DOOR	130.72
W1842	WALL - 18"W x 12"D x 42"H - 1 DOOR	145.16
W2142	WALL - 21"W x 12"D x 42"H - 1 DOOR	174.80
W2442	WALL - 24"W x 12"D x 42"H - 2 DOORS	187.72
W2742	WALL - 27"W x 12"D x 42"H - 2 DOORS	218.88
W3042	WALL - 30"W x 12"D x 42"H - 2 DOORS	243.20
W3342	WALL - 33"W x 12"D x 42"H - 2 DOORS	256.12
W3642	WALL - 36"W x 12"D x 42"H - 2 DOORS	272.84

**12" HIGH WALL CABINETS**

W3012	WALL - 30"W x 12"D x 12"H - 2 DOORS	91.20
W3312	WALL - 33"W x 12"D x 12"H - 2 DOORS	96.52
W3612	WALL - 36"W x 12"D x 12"H - 2 DOORS	102.60
W3912	WALL - 39"W x 12"D x 12"H - 2 DOORS	111.72

**15" HIGH WALL CABINETS**

W3015	WALL - 30"W x 12"D x 15"H - 2 DOORS	101.84
W3315	WALL - 33"W x 12"D x 15"H - 2 DOORS	110.20
W3615	WALL - 36"W x 12"D x 15"H - 2 DOORS	112.48

**18" HIGH WALL CABINETS**

W2418	WALL - 24"W x 12"D x 18"H - 2 DOORS	98.04
W3018	WALL - 30"W x 12"D x 18"H - 2 DOORS	112.48
W3318	WALL - 33"W x 12"D x 18"H - 2 DOORS	120.84
W3618	WALL - 36"W x 12"D x 18"H - 2 DOORS	128.44

### 24" HIGH WALL CABINETS

W2424	WALL - 24"W x 12"D x 24"H - 2 DOORS	125.40
W3024	WALL - 30"W x 12"D x 24"H - 2 DOORS	142.12
W3324	WALL - 33"W x 12"D x 24"H - 2 DOORS	151.24
W3624	WALL - 36"W x 12"D x 24"H - 2 DOORS	161.88
W361224	WALL - 36"W x 24"D x 12"H - 2 DOORS	138.32
W361824	WALL - 36"W x 24"D x 18"H - 2 DOORS	174.80
W362424	WALL - 36"W x 24"D x 24"H - 2 DOORS	189.24

\*\*\*\*\*NOTE: TIMES SQUARE MAPLE DOUBLE DOOR CABINETS HAVE BUTT DOORS

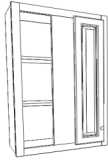

### WALL BLIND

6" CENTER BOARD (FULL OVERLAY WITH 7" CENTER BOARD)		
WBC3630 L/R	WALL BLIND CORNER - 36"W x 12"D x 30"H - 1 DOOR	182.40
WBC3636 L/R	WALL BLIND CORNER - 36"W x 12"D x 36"H - 1 DOOR	225.72
WBC3642 L/R	WALL BLIND CORNER - 36"W x 12"D x 42"H - 1 DOOR	268.28

\*\*\* MINIMUM COVERAGE 36" PULL TO 39"  
 \*\*\* INSTALLING AN ADJACENT WALL CABINET REQUIRES AT LEAST A 1/2" FILLER FOR DOOR TO OPEN

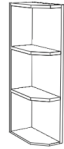
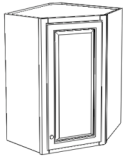

### WALL DIAGONAL & WALL END

WDC2430	WALL DIAGONAL CORNER - 24"W x 12"D x 30"H - 1 DOOR	202.92
WDC2436	WALL DIAGONAL CORNER - 24"W x 12"D x 36"H - 1 DOOR	253.84
WDC2442	WALL DIAGONAL CORNER - 24"W x 12"D x 42"H - 1 DOOR	269.80
WES530	WALL END SHELF - 11-1/4"W x 5"D x 30"H x 1/8" T - 2 SHELVES	58.52
WES536	WALL END SHELF - 11-1/4"W x 5"D x 36"H x 1/8" T - 2 SHELVES	70.68
WES542	WALL END SHELF - 11-1/4"W x 5"D x 42"H x 1/8" T - 2 SHELVES	82.84
AW30	WALL TRIANGLE END CABINET - 17" x 12" x 12" x 30"H (WITH DOOR)	138.32
AW36		166.44
AW42	WALL TRIANGLE END CABINET - 17" x 12" x 12" x 42"H (WITH DOOR)	193.80

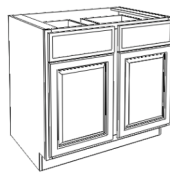
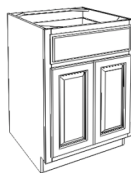

### BASE CABINETS

*****NOTE: SPICE MAPLE DOUBLE DOOR CABINETS HAVE BUTT DOORS EXCEPT B39, B42, B48		
B09	BASE - 9"W x 24"D x 34-1/2"H - 1 DOOR 1 DRAWER	121.60
B12	BASE - 12"W x 24"D x 34-1/2"H - 1 DOOR 1 DRAWER	139.09
B15	BASE - 15"W x 24"D x 34-1/2"H - 1 DOOR 1 DRAWER	145.92
B18	BASE - 18"W x 24"D x 34-1/2"H - 1 DOOR 1 DRAWER	153.52
B21	BASE - 21"W x 24"D x 34-1/2"H - 1 DOOR 1 DRAWER	174.80
B24	BASE - 24"W x 24"D x 34-1/2"H - 2 DOORS 1 DRAWER	188.48
B27	BASE - 27"W x 24"D x 34-1/2"H - 2 DOORS 1 DRAWER	204.44
B30	BASE - 30"W x 24"D x 34-1/2"H - 2 DOORS 2 DRAWERS	228.76
B33	BASE - 33"W x 24"D x 34-1/2"H - 2 DOORS 2 DRAWERS	240.16

B36	BASE - 36"W x 24"D x 34-1/2"H - 2 DOORS 2 DRAWERS	251.56
B39	BASE - 39"W x 24"D x 34-1/2"H - 2 DOORS 2 DRAWERS	267.52
B42	BASE - 42"W x 24"D x 34-1/2"H - 2 DOORS 2 DRAWERS	282.72
B48	BASE - 48"W x 24"D x 34-1/2"H - 2 DOORS 2 DRAWERS	322.24

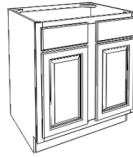

### SINK BASE

*****NOTE: SPICE MAPLE DOUBLE DOOR CABINETS HAVE BUTT DOORS EXCEPT 42"		
SB27	SINK BASE - 27"W x 24"D x 34-1/2"H - 2 DOORS 2 HEADERS	199.12
SB30	SINK BASE - 30"W x 24"D x 34-1/2"H - 2 DOORS 2 HEADERS	205.96
SB33	SINK BASE - 33"W x 24"D x 34-1/2"H - 2 DOORS 2 HEADERS	213.56
SB36	SINK BASE - 36"W x 24"D x 34-1/2"H - 2 DOORS 2 HEADERS	221.92
SB42	SINK BASE - 42"W x 24"D x 34-1/2"H - 2 DOORS 2 HEADERS	233.32

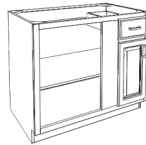

### BASE BLIND

BCC3639 L/R	BASE BLIND CORNER - 36"W x 24"D x 34-1/2"H - 1 DOOR 1 DRAWER	271.32
*** 42" MINIMUM COVERAGE PULL TO 45"	*** 6" CENTER BOARD (FULL OVERLAY W/ 4 3/4")	
BLB3639 L/R	27"W (9+9+9) x 24"D x 34-1/2"H - 1 DOOR 1 DRAWER	AVAIL 6/08
*** 36" MINIMUM COVERAGE PULL TO 39"	*** 9" CENTER BOARD	

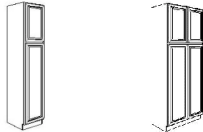

### UTILITY AND PANTRY

\*\*\*\*\*NOTE: SPICE MAPLE DOUBLE DOOR CABINETS HAVE BUTT DOORS. ALL PANTRIES HAVE 2 FIXED SHELVES & 3 ADJUSTABLE SHLVES

WP1884 L/R	WALL PANTRY 18"W x 24"D x 84"H - 2 DOORS	456.76
WP2484	WALL PANTRY 24"W x 24"D x 84"H - 4 DOORS	572.28
WP1890 L/R	WALL PANTRY 18"W x 24"D x 90"H - 2 DOORS	491.72
WP2490	WALL PANTRY 24"W x 24"D x 90"H - 4 DOORS	615.60
WP1896 L/R	WALL PANTRY 18"W x 24"D x 96"H - 2 DOORS	525.16
WP2496	WALL PANTRY 24"W x 24"D x 96"H - 4 DOORS	658.92



### MICROWAVE & OVEN

MICROWAVE OVEN - OPENING - 27"W x 14-1/2"H EXCLUDING SHELF		
MWO3018PM	MICROWAVE OVEN - 30"W x 12"D x 18"H (18"D x 3/4" T SHELF)	109.44
OC3084	DOUBLE OVEN CABINET - 30"W x 24"D x 84"H (26-3/4" W 31-1/2"H OPENING)	NA
OC3096	DOUBLE OVEN CABINET - 30"W x 24"D x 96"H (26-3/4" W 31-1/2"H OPENING)	NA
OC3384	DOUBLE OVEN CABINET - 33"W x 24"D x 84"H	710.60
OC3390	DOUBLE OVEN CABINET - 33"W x 24"D x 90"H	763.80
OC3396	DOUBLE OVEN CABINET - 33"W x 24"D x 96"H	817.00
*** NOTE : DOUBLE OVEN CABINETS ARE FOR A CONVENTIONAL OVEN AND A MICROWAVE OVEN		



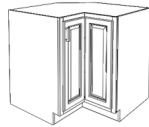

**DRAWER STACKS & CORNER CABINETS**

DB12(3)	DRAWER PACK - 12"W x 24"D x 34-1/2"H - 3 DRAWERS	228.00
DB15(3)	DRAWER PACK - 15"W x 24"D x 34-1/2"H - 3 DRAWERS	239.40
DB18(3)	DRAWER PACK - 18"W x 24"D x 34-1/2"H - 3 DRAWERS	246.24
DB21(3)	DRAWER PACK - 21"W x 24"D x 34-1/2"H - 3 DRAWERS	254.60
DB24(3)	DRAWER PACK - 24"W x 24"D x 34-1/2"H - 3 DRAWERS	254.60
DB30(3)	DRAWER PACK - 30"W x 24"D x 34-1/2"H - 3 DRAWERS	453.72
DB36(3)	DRAWER PACK - 36"W x 24"D x 34-1/2"H - 3 DRAWERS	469.68
AB24	BASE ANGLE W\ 2 DOORS & 1 ADJ SHELF-18-1/2" x 18-1/2" x 24"	350.36
LS3309	LAZY SUSAN - 33"W x 34-1/2"H - 1 BIFOLD DOOR & 1 REVOLVING SHELF	NA
LS3309S	EASY REACH 33"W x 34-1/2"H - 1 BIFOLD DOOR - FIXED SHELF, NOT REVOLVING	364.80
LS3612	LAZY SUSAN - 36"W x 34-1/2"H - 1 BIFOLD DOOR & 1 REVOLVING SHELF	397.48



**GLASS DOORS & DOOR FRAME ( SPICE MAPLE - MULLION STYLE)**

W1530GD	GLASS DOOR ONLY - FOR W1530	53.20
W1830GD	GLASS DOOR ONLY - FOR W1830	69.92
W3030GD	GLASS DOOR ONLY - FOR W3030 (SET OF 2 DOORS)	108.68
W3630GD	GLASS DOOR ONLY - FOR W3630 (SET OF 2 DOORS)	NA
WDC2430GD	GLASS DOOR ONLY - FOR WDC2430	57.00
W1536GD	GLASS DOOR ONLY - FOR W1536	63.84
W1836GD	GLASS DOOR ONLY - FOR W1836	83.60
W3036GD	GLASS DOOR ONLY - FOR W3036 (SET OF 2 DOORS)	130.72
W3636GD	GLASS DOOR ONLY - FOR W3636 (SET OF 2 DOORS)	171.76
WDC2436GD	GLASS DOOR ONLY - FOR WDC2436	68.40
W1542GD	GLASS DOOR ONLY - FOR W1542	74.48
W1842GD	GLASS DOOR ONLY - FOR W1842	98.04
W3042GD	GLASS DOOR ONLY - FOR W3042 (SET OF 2 DOORS)	NA
W3642GD	GLASS DOOR ONLY - FOR W3642 (SET OF 2 DOORS)	NA
WDC2442GD	GLASS DOOR ONLY - FOR WDC2442	79.80

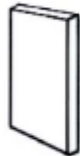
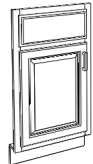

**PANELS**

DWR33412(3)SOLID	DISHWASHER PANEL - 24" x 34-1/2" x 5/8" x 3" RETURN - SOLID	49.40
FBP489614(1)	FINISH BACK PANELS - 48" x 96" x 1/4" (1 SIDE FINISH)	110.96
REF2484(3)	REFRIGERATOR END PANEL - 24" x 84" x 3" RETURN - SOLID	158.84
REF2496(3)	REFRIGERATOR END PANEL - 24" x 96" x 3" RETURN - SOLID	190.00
REF2484	REFRIGERATOR END PANEL - 24" x 84" x 1/2" T	136.80
REF2496	REFRIGERATOR END PANEL - 24" x 96" x 1/2" T	156.56



**ACCESSORIES**

W3018WR	WINE RACK - 30"W x 12"D x 18"H	139.84
---------	--------------------------------	--------

18RT	ROLL-OUT TRAY - 18"W (HARDWARE INCLUDED)	45.21
24RT	ROLL-OUT TRAY - 24"W (HARDWARE INCLUDED)	64.60
30RT	ROLL-OUT TRAY - 30"W (HARDWARE INCLUDED)	75.24
***ROLL TRAYS ARE NATURAL COLOR & CAN BE USED WITH ALL 3 LINES***		

### FILLERS

WF3-SOLID 3/4	WALL FILLER - 3" x 30" x 3/4" T - SOLID	12.95
WF6-SOLID 3/4	WALL FILLER - 6" x 30" x 3/4" T - SOLID	28.12
WF336-SOLID 3/4	WALL FILLER - 3" x 36" x 3/4" T - SOLID	16.72
WF342-SOLID 3/4	WALL FILLER - 3" x 42" x 3/4" T - SOLID	19.76
WF384-SOLID 3/4	WALL FILLER - 3" x 84" x 3/4" T - SOLID	39.52
WF396-SOLID 3/4	WALL FILLER - 3" x 96" x 3/4" T - SOLID	46.36
DÉCOR FLUTED FILLERS- CANNOT BE TRIMMED		
A24WF	DÉCOR WALL FILLER - 3" x 24"	19.00
A30WF	DÉCOR WALL FILLER - 3" x 30"	22.80
A36WF	DÉCOR WALL FILLER - 3" x 36"	26.60
A42WF	DÉCOR WALL FILLER - 3" x 42"	31.92
BF3-SOLID 3/4	BASE FILLER - 3" x 34-1/2" x 3/4" - SOLID	22.80
BF6-SOLID 3/4	BASE FILLER - 6" x 34-1/2" x 3/4" - SOLID	38.00
A3BF-SOLID	DÉCOR BASE FILLER - 3" x 34-1/2"	31.16

### VALANCES

VA48-SOLID	VALANCE 48" - SOLID 4-1/2" WIDE	22.80
VA548-SOLID	SCULPTURE VALANCE 48" - SOLID	22.04

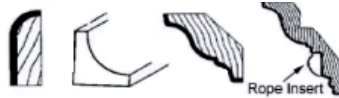

### MOLDINGS

SC1-3	MOLDING - 3/4"W x 96"L x 1/4" T - 1 SIDE BULL NOSE	12.92
SC4	MOLDING - 3/4"W x 3/4"W x 96"L INSIDE CORNER	NA
SC5	OUTSIDE CORNER MOLDING 3/4 x 3/4 x 96L x 1/4T	16.72
CM96	CROWN MOLDING - 96" X 2-1/2"	46.36
CM96C-4	CROWN MOLDING - 96" x 4 1/2" (WITH ROPE INSERT)	102.60
LRM8	UNDER WALL CABINET MOLDING - 96" x 1-1/2" x 1"	50.92
OCM8	96" OUTSIDE CORNER MOLDING	24.32
TK8	8' TOE KICK	30.40

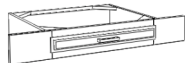

### VANITIES

S2421	VANITY - 24" x 21" x 30" - 2 DOORS	138.32
S2421-34 1/2	VANITY - 24" x 21" x 34 1/2" - 2 DOORS	158.84
S3021	VANITY - 30" x 21" x 30" - 2 DOORS	174.04
S3021-34 1/2	VANITY - 30" x 21" x 34 1/2" - 2 DOORS	199.88
S3621	VANITY - 36" x 21" x 30" - 2 DOORS	209.76
S3621-34 1/2	VANITY - 36" x 21" x 34 1/2" - 2 DOORS	242.44
SVBS4221D	VANITY - 42" x 21" x 30" - 2 DOORS, 2 DRAWERS ON TOP	312.36
SVDU3021	SINGLE DESK CABINET DRAWER - 30" x 7" x 21"	70.68
SVB1221	DRAWER PACK - 12" x 21" x 30" - 3 DRAWERS	223.44
SVB1221-34-1/2	DRAWER PACK - 12" x 21" x 34 1/2" - 3 DRAWERS	256.88
SVB1521	DRAWER PACK - 15" x 21" x 30" - 3 DRAWERS	235.60
SVB1521-34-1/2	DRAWER PACK - 15" x 21" x 34 1/2" - 3 DRAWERS	270.56
SVB1821	DRAWER PACK - 18" x 21" x 30" - 3 DRAWERS	249.28
SVB1821-34-1/2	DRAWER PACK - 18" x 21" x 34 1/2" - 3 DRAWERS	286.52

\*\* ALL ABOVE INFORMATION IS FOR REFERENCE ONLY, ACTUAL ITEM MAY HAVE SLIGHTLY DIFFERENT CONFIGURATION.